

QOT INTEGRATION KIT - PACKAGE INSERT

DELIVERY PARTS

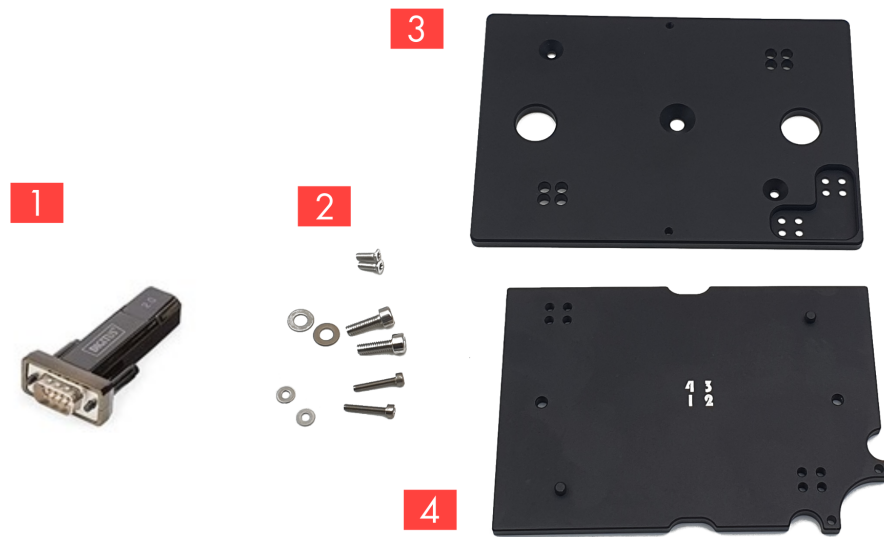

- | | |
|--------|--|
| Part 1 | QOT USB/RS232 converter
<i>To identify QINSTRUMENTS devices and use them in parallel with other instruments a programmed converter is required.</i> |
| Part 2 | Set of screws for mounting
<i>2x ISO 14581 M3 x 8</i>
<i>2x DIN 912 M2.5 x 14</i>
<i>2x DIN 912 M4 x 16</i>
<i>2x DIN125 A2.7 - A2</i>
<i>2x DIN125 A4.3 - A2</i> |
| Part 3 | QI plate
<i>Plate to mount QINSTRUMENTS device to</i> |
| Part 4 | OT plate
<i>Plate that is connected to the OT-2 deck</i> |
| Part 5 | QOT python module (software - not displayed)
<i>A set of Python modules that extends the Opentrons API to use QINSTRUMENTS devices. The latest release is available for download on the homepage.</i>
https://www.qinstruments.com/fileadmin/Application/08-Opentrons/QOT_python_module.zip |